

PROPOSED FIRE HYDRANTE WORK STATE BANK OF INDIA AO RANCHI AT JHARKHAND						
BOQ OF PROPOSED FIRE HYDRANT WORK STATE BANK OF INDIA AO & RBO RANCHI BUILDING AT JHARKHAND						16-02-2026
DETAILED ESTIMATE						
S. NO.	DESCRIPTION	Approved Make	Unit	Qty.	RATE	AMOUNT
SUBHEAD-I: FIRE PUMPS AND HYDRANT WORKS.						
1	FIRE PUMPS - ELECTRICAL					
	Supplying, installation, testing and commissioning of Electric driven Main Fire Pump suitable for automatic operation and consisting of following, complete in all respects, as required:	Lubi, Kirloskar, Wilo, KSB				
	Horizontal type, multistage, centrifugal, split casing pump of cast iron body & bronze impeller with stainless steel shaft, mechanical seal conforming to IS 1520.					
	Suitable HP Squirrel cage induction motor, TEFC, synchronous speed 1500 RPM, suitable for operation on 415 volts, 3 phase 50 Hz, AC supply with IP 55 protection for enclosure, horizontal foot mounted type with Class-'F' insulation, conforming to IS-325.					
	M.S. fabricated Common base plate, coupling, coupling guard, foundation bolts etc. as required.					
	Suitable cement concrete foundation duly plastered with anti vibration pads.					
	2280 lpm at 70 m Head		Set	1.00		
2	Supplying, installation, testing and commissioning of electric driven pressurization pump suitable for automatic operation and consisting of following, complete in all respects, as required: (Jockey Pump)	Lubi, Kirloskar, Wilo, KSB				
	Horizontal type, multistage, centrifugal pump of cast iron body and bronze impeller with stainless steel shaft, mechanical seal conforming to IS: 1520.					
	Suitable HP squirrel cage induction motor TEFC type suitable for operation on 415 volts, 3 phase 50 Hz AC supply with IP 55 class of protection for enclosure, horizontal foot mounted type with Class-'F' insulation, conforming to IS: 325.					
	M.S. fabricated Common base plate, coupling, coupling guard, foundation bolts etc. as required.					
	Suitable cement concrete foundation duly plastered and with anti vibration pads.					
	180 lpm at 70 m Head		Set	1.00		
3	FIRE PUMPS - DIESEL					
	Supplying, installation, testing and commissioning of diesel engine driven main fire pump suitable for automatic operation and consisting of following, complete in all respects, as required: (Diesel Driven Pump)	Lubi, Kirloskar, Wilo, KSB				
	Horizontal type, multistage, centrifugal pump of cast of iron body and bronze impeller with stainless steel shaft, mechanical seal conforming to IS 1520.					
	Suitable HP, 1500 RPM water cooled with radiator, diesel engine conforming to relevant IS standard complete with auto starting mechanism, 12 /24 volts electric starting equipment, diesel tank, exhaust pipe extended up to 10 m outside pump house duly insulated with 50 mm thick glass wool with 1.0 mm thick aluminum sheet cladding, residential silencer, instruments and protection as per standard specification, stop solenoid for auto stop in the event of fault with audio indications, painted with post office red colour etc. as required.					

	M.S fabricated, common base plate, coupling, coupling guard, foundation bolts etc. as required.					
	Suitable cement concrete foundation duly plastered and with anti vibration pads.					
	2280 lpm at 70 m Head.		Set	1.00		
4	FIRE ROOF PUMPS - ELECTRICAL					
	Supplying, installation, testing and commissioning of electric driven terrace pump suitable for automatic operation and consisting of following, complete in all respects, as required: (Terrace Pump)	Lubi, Kirloskar, Wilo, KSB				
	Horizontal type, multistage, centrifugal pump of cast of iron body and bronze impeller with stainless steel shaft, mechanical seal conforming to IS 1520.					
	Suitable HP squirell cage induction motor TEFC type suitable for operation on 415 volts, 3 phase, 50 Hz, AC supply with IP55 class of protection for enclosure, horizontal foot mounted type with Class-'F' insulation, conforming to IS-325.					
	M.S fabricated, common base plate, coupling, coupling guard, foundation bolts etc. as required.					
	Suitable cement concrete foundation duly plastered and with anti vibration pads.					
	900 lpm at 35 m Head.		Set	1.00		
5	Fabricating, supplying, testing and commissioning of electrical control panel of cubicle construction, floor mounted type, fabricated out of 2mm thick crca sheet, compartmentalized and hinged lockable doors, dust and vermin proof, powder coated approved shade after 7 tank treatment process, cable alley interconnection, having switchgears and accessories mounting and internal wiring, earth terminals, numbering etc., complete in all respects, suitable for operation on 415V, 3 phase 50 Hz., AC supply with enclosure protection class IP-42as required.	IMPACT ENGINEERS/ELEGANT				
	COMMON PANEL IN FIRE PUMP HOUSE.					
	INCOMER		Set	1.00		
	400A, 50kA 4 Pole MCCB, Ics=100% Icu rating					
	Digital Voltmeter 0-500V with selector switch					
	Ammeter (0-400 A) with selector switch & CTs etc.					
	LED type RYB phase indicating lamps, ON, OFF, trip indicating lamps					
	Set of Copper Bus Bar 800Amps					
	OUTGOING.					
	Main fire pump and Sprinkler pump					
	200 A, 50kA TPN MCCB, Ics=100% Icu, with fully automatic Star/Delta starter suitable for 100 hp pump with overload protection, current sensing type single phase preventor complete with all accessories and internal wiring required for automatic operation, selector switch for local/remote, auto/manual/OFF operation. - 2 sets					
	Jockey pump					
	100 A, 50kA TPN MCCB, Ics=100% Icu, with Suitable HP fully automatic Star/Delta starter with overload protection, current sensing type single phase preventor complete with all accessories and internal wiring required for automatic operation, selector switch for local/remote, auto/manual/OFF operation. - 2 sets					
	Diesel Engine Control					
	Control for Diesel Engine comprising: -					
	Auto / Manual selector switch & 3 attempt starting device, timers and relays as required, push buttons, start / stop in manual mode.					
	Indication lamp for High / Low Lub. Oil pressure, High Water Temp. and Engine ON indication.					
	Battery charger suitable for 12V / 24 V DC with boost and tickle selector switch, 0-30 V DC volt meter, 0-20A DC Ammeter.					

	All standard relays and accessories for automatic operation of diesel engine.					
	Diesel Engine Control					
	Control for Diesel Engine comprising: -					
	Auto / Manual selector switch & 3 attempt starting device, timers and relays as required, push buttons, start / stop in manual mode.					
	Indication lamp for High / Low Lub. Oil pressure, High Water Temp. and Engine ON indication.					
	Battery charger suitable for 12 V / 24 V DC with boost and tickle selector switch, 0-15 V / 0-30 V DC volt meter, 0-20A DC Ammeter.					
	All standard relays and accessories for automatic operation of diesel engine					
	SYSTEM CONTROLLER					
	Designing, Supply, Installation, Testing and Commissioning of system controller to control operation of Main Electric Fire Pump, Diesel Pump in sequence as per specification consisting of relays, timers, sensors, annunciation window for fault indication, complete as per specification.					
	Note - All cabling, earthing, GI strip and cable tray including all electrical related accessories included in the tender. The vendor/team carrying out Electrical works must have valid Electrical license.					
6	Providing & fixing of pressure switch in M.S. pipe line including connection etc. as required.	INDFOSS/SWITZER/WAREE	Each	6.00		
7	Supplying and fixing air vessel made of 250 mm dia, 8 mm thick MS sheet, 1200 mm in height with air release valve on top and flanged connection to riser, drain arrangement with 25 mm dia gun metal wheel valve with required accessories, pressure gauge and painting with synthetic enamel paint of approved shade as required.	SAFEGUARD / NEWAGE/ FIRE SHIELD / LIFE GUARD	Each	2.00		
I	TOTAL C/F TO SUMMARY					
8	Supplying and fixing single headed internal hydrant valve with instantaneous Gunmetal/Stainless Steel coupling of 63 mm dia with cast iron wheel ISI marked conforming to IS 5290 (Type -A) with blank Gunmetal/Stainless Steel cap and chain as required:	SAFEGUARD / NEWAGE/ FIRE SHIELD / LIFE GUARD	Set	12.00		
	Single headed Gunmetal					
9	Supplying and fixing Single headed external yard hydrant valve with 1 No. 63 mm dia instantaneous FM Gunmetal/Stainless Steel coupling and cast-iron wheel, ISI marked, conforming to IS 5290 (type A) with blank Gunmetal/Stainless Steel cap and chain as required:	SAFEGUARD / NEWAGE/ FIRE SHIELD / LIFE GUARD				
a	Single headed Gunmetal		Set	5.00		
10	Supplying and fixing first-aid Hose Reel with MS construction spray painted in post office red, conforming to IS 884 complete with the following as required.	SAFEGUARD / NEWAGE/ FIRE SHIELD / LIFE GUARD				
	20 mm nominal internal dia water hose thermoplastic (Textile reinforced) type -2 as per IS: 12585					
	20 mm nominal internal dia gun metal globe valve & nozzle.					
	Drum and brackets for fixing the equipment on wall					
	Connections from riser with 25 mm dia stop gun metal valve & M.S. Pipe and socket.					
	30 m		Set	12.00		
11	Supplying and fixing 63 mm dia, 15 m long RRL hose pipe with 63 mm dia male and female couplings duly bound with GI wire, rivets etc. conforming to IS 636 (type-A) as required:	SAFEGUARD / NEWAGE/ FIRE SHIELD / LIFE GUARD				
	Gun Metal		Set	34.00		

12	Supplying & fixing 63 mm dia gun metal short branch pipe with 20 mm nominal internal diameter size nozzle conforming to IS 903 suitable for instantaneous connection to interconnect hose pipe coupling as required:	SAFEGUARD / NEWAGE/ FIRE SHIELD / LIFE GUARD				
	Providing and fixing of standard short size GM branch pipe with nozzle of 20mm nominal bore outlet with instantons type 63 mm dia coupling complete IS marked & TAC approved.		Nos.	17.00		
13	Supplying and fixing orifice plate made out of 6 mm thick stainless steel (Grade 304) with orifice of required size to be fitted between flange & landing valve of external and internal hydrants to reduce pressure at the outlet to the level of 3.5 kg/cm2 complete as required.	SAFEGUARD / NEWAGE/ FIRE SHIELD / LIFE GUARD	Each	17.00		
14	Supplying and fixing of fire brigade connection of cast iron body with gun metal male instantaneous inlet couplings complete with cap and chain as reqd. for suitable dia MS pipe connection conforming to IS 904 as required:	SAFEGUARD / NEWAGE/ FIRE SHIELD / LIFE GUARD				
	4 way - 150 mm dia M.S. Pipe		Set	2.00		
15	2 way - 100 mm dia M.S. Pipe		Set	1.00		
II	TOTAL C/F TO SUMMARY					
	SUBHEAD III: FIRE HYDRANT ELECTRICAL WORKS (DSR 2022)					
16	Supplying and Earthing with GI earth plate 600mm x 600 mm x 6mm thick including accessories and providing masonry enclosure with cover plate having locking arrangement and watering pipe etc., with charcoal/ coke and salt as required.	ISI Mark	Set	2.00		
17	Supplying and laying 25 mm x 5 mm. G.I. strip in 40 mm dia. G.I. Pipe from earth electrode, including connection with GI nut, bolt, spring, washer excavation and re-filling etc. as required.	ISI Mark	Rm	30.00		
18	Providing & fixing 25mm x 5mm G.I. strip on surface or in recess for connections etc. as required.	ISI Mark	Rm	100.00		
19	Providing and Fixing 6 SWG dia G.I. wire on surface or in recess for loop earthing along with existing surface/ recessed conduit/ submain wiring/ cable as required.	ISI Mark	Rm	160.00		
20	Supplying, fabricating and installing following size of perforated painted with powder coating M.S. cable trays, with perforation not more than 17.5%, in convenient section, joined with connectors, suspended from the ceiling with MS suspenders including bolts & nuts, painting suspenders etc. as required.	SLOTCO OR EQUIVALENT				
a	100 mm width X 50 mm depth X 1.6 mm thickness		Rm	30.00		
b	300 mm width X 50 mm depth X 1.6 mm thickness		Rm	20.00		
21	Laying and fixing of One number PVC Insulated and PVC Sheathed/XLPE power cable of 1.1 kV grade of size not exceeding 35 sqmm on surface as required.		RM	16.00		
22	Laying and fixing of One number PVC Insulated and PVC Sheathed/XLPE power cable of 1.1 kV grade of following size on wall surface as required.					
	Above 35 sq mm and up to 95 sq mm (clamed with 25x3mm MS flat clam)		RM	265		
23	Supplying of all materials and making terminations of 1.1 KV grade aluminum multicore cables of the following sizes. The work includes cable glanding using brass plated double compression glands, sizing the core leads, removing insulation, fixing suitable crimping type copper lugs/ thimbles by using hydraulic crimping tools with correct size of the dies, shaping the leads and neatly connecting the same to the equipment terminals.	Havells / KEI / Polycab / Finolex				

a	3.5 Core 120 sq. mm. Armored Aluminum cable.		Mtr	10.00		
b	3.5 Core 35 sq. mm. Armored Aluminum cable.		Mtr	30.00		
c	3.5 Core 16 sq. mm. Armored Aluminum cable.		Mtr	16.00		
24	Control Cabling (PVC insulated and PVC sheathed, armored, Copper Conductor of 1.1 KV grade on existing cable trays).	Havells / KEI / Polycab / Finolex				
	5C x 1.5 Sq. mm		RM	105.00		
III	TOTAL C/F TO SUMMARY					
	SUBHEAD-IV: PIPING FOR FIRE FIGHTING SYSTEM					
25.0	Providing and fixing C.I. double acting air valves of approved quality with bolts, nuts, rubber insertions etc. complete (The tail pieces, tapers etc. if reqd. will be paid separately)	Customise as per requirement				
a	50 mm dia.		Each	3.00		
26	Excavating trenches of required width for pipes, cables, etc. including excavation for sockets, and dressing of sides, ramming of bottoms, depth up to 1.5 m including getting out the excavated soil, and then returning the soil as required, in layers not exceeding 20 cm in depth including consolidating each deposited layer by ramming, watering, etc. and disposing of surplus excavated soil as directed, within a lead					
	All kinds of soil					
	Pipes, cables etc. exceeding 80 mm dia. but not exceeding 300 mm dia.		MTS	145		
27	Providing and fixing up to floor five level precast cement concrete string or lacing courses, copings, bed plates, anchor blocks, plain window sills, shelves, louvers, steps, stair cases, etc. including hoisting and setting in position with cement mortar 1:3 (1 Cement : 3 coarse sand), cost of required centering, shuttering and finishing smooth with 6mm thick cement plaster 1:3 (1 Cement : 3 fine sand) on exposed surfaces complete.					
	1:1.5:3 (1 cement: 1.5 coarse sand: 3 graded stone aggregate 20mm nominal size).		Cum	4		
28	Supplying, fixing, testing & commissioning of double flanged sluice valve of rating PN 1.6 with non-rising spindle, bronze/gun metal seat, ISI marked complete with nuts, bolts, washers, gaskets and conforming to IS 780 of following sizes as required:	AUDCO/ZOLOTO/SANT/DRP				
a	100 mm dia. pipe		Each	1.00		
b	150 mm dia. pipe		Each	3.00		
c	200 mm dia. pipe		Each	2.00		
29	Providing, installation, testing and commissioning of stainless-steel Y-strainer fabricated out of 1.6 mm thick stainless steel, Grade 304, sheet with 3 mm dia holes with stainless steel flange.	AUDCO/ZOLOTO/SANT/DRP				
a	100 mm dia.		Each	2.00		
b	150 mm dia.		Each	1.00		
c	200 mm dia.		Each	2.00		
30	Providing, installation, testing and commissioning of non-return valve of following sizes conforming to IS:5312 complete with rubber gasket, GI bolts, nuts, washers etc.as required:	AUDCO/ZOLOTO/SANT/DRP				
A	80 mm dia		Each	1.00		
B	100 mm dia		Each	1.00		
C	150 mm dia		Each	3.00		

31	Supplying, fixing, testing and commissioning of butterfly valve of PN 1.6 rating with bronze/gunmetal seat duly ISI marked complete with nuts, bolts, washers, gaskets conforming to IS 13095 of following sizes as required:	AUDCO/ZOLOTO/SA NT/ DRP				
A	80 mm dia		Each	2.00		
B	100 mm dia		Each	5.00		
C	150 mm dia		Each	20.00		
D	200 mm dia		Each	0.00		
32	Providing laying, testing & commissioning of 'C' class heavy duty MS Pipe conforming to IS 1239/3589 i/c fittings like elbows, tees, flanges, tapers, nuts bolts, gaskets etc. in ground including welding, excavation & providing cement concrete blocks as supports, anticorrosive treatment with coal tar/asphalt tape as per IS 10221, refilling the trench etc. of following sizes complete as required.	Jindal Hissar /TATA/Prakash Surya				
a	200 nominal bore (class C)		M	0.00		
b	150 nominal bore (class C) including 100-65 dia pipe)		M	60.00		
33	Providing, laying, testing & commissioning of 'C' class heavy duty MS pipe conforming to IS 3589/IS 1239 including Welding, fittings like elbows, tees, flanges, tapers, nuts bolts, gaskets etc. and fixing the pipe on the wall/ceiling with suitable clamp/support frame and painting with two or more coats of synthetic enamel paint of required	Jindal Hissar /TATA/Prakash Surya				
a	250 mm nominal bore (class C)		Rm	10.00		
b	200 mm nominal bore (class C)		Rm	10.00		
c	150 mm nominal bore (class C)		Rm	145.00		
d	100 mm nominal bore (class C)		Rm	200.00		
e	80 mm nominal bore (class C)		Rm	0.00		
f	65 mm nominal bore (class C)		Rm	20.00		
g	50 mm nominal bore (class C)		Rm	12.00		
h	40 mm nominal bore (class C)		Rm	4.00		
i	32 mm nominal bore (class C)		Rm	1.00		
j	25 mm nominal bore (class C)		Rm	52.00		
34	Providing, fixing, testing & commissioning of 15mm dia quartzoid bulb type sprinklers of rating 68 degree centigrade with required accessories:	VICTAULIC / TYCO / VIKING				
a	Pendent Sprinkler		Each	1.00		
b	Upright Sprinkler		Each	16.00		
c	Horizontal side wall sprinkler		Each	1.00		
d	Concealed sprinkler		Each	1.00		
35	Providing & fixing flow switch in following sizes M.S. pipe including connection etc. as required.	VICTAULIC / TYCO / VIKING /Honeywell				
a	100mm dia		Each	5.00		
36	Providing & fixing of pressure switch in M.S. pipe line including connection etc. as required.	Infosys/ donfos / Switcher	Each	5.00		
37	Providing, fixing, testing & commissioning of installation control valve of cast iron body, brass/bronze working parts comprising of water motor alarm, bronze seat clapper, clapper arm and hydraulically driven mechanical gong bell to sound continuous alarm when the wet riser/sprinkler system activates, pressure gauges, emergency releases, strainer, pressure switch, cock valve complete with drain valve and bypass, test control box, ball valves, MS pipe of required size, flanges, orifice plate, gasket etc. of following sizes as required :	Shah Bhogilal / KBL / Upadhya/ Kalpana/ Kartar/Zoloto/Audco /Sant				
a	100mm dia		Each	1.00		

38	Supplying, installation, testing & commissioning of sprinkler flexible pipe (UL Listed) of stainless steel complete with 15 NPT on reducer thread with maximum working pressure of 175 PSI test pressure of 875 PSI (Burst) with branch line (Inlet) 25mm NPT male thread to sprinkler head (Outlet) 15mm NPT female thread with reducer, nipple, 2 side brackets, center bracket, stockbar of following sizes complete as	VICTAULIC / TYCO / VIKING /				
a	1200mm		Set	2.00		
39	Providing and placing on terrace (at all floor levels) polyethylene water storage tank, IS: 12701 marked, with cover and suitable locking arrangement and making necessary holes for inlet, outlet and overflow pipes but without fittings and the base support for tank.	ASTRAL / PRINCE / ASHIRVAD	Per litre	10000.00		
IV TOTAL C/F TO SUMMARY						
SUBHEAD- V: FIRE NON SCHEDULED ITEMS						
40	Providing and fixing of TAC approved 1.6mm thick M.S. fire hose cabinet (750x600x250mm) made out of 16-gauge M.S. sheet capable of accommodating landing valve, hose pipes, fittings & accessories. The box shall have a front glass door with lock and key arrangement & shall be painted with post office red colour (approval shall be taken on the basis of submitted sample before ordering) - for external and roof hydrant.	SAFEGUARD / NEWAGE/ FIRE SHIELD / LIFE GUARD	Each	17.00		
41	Supply, installation testing & commissioning Foot Valve lift type as per specifications to the satisfaction of Project-in-charge - 150mm dia	ZOLOTO/SANT/ DRP	Each	2.00		
42	Providing and fixing brass ball valve with SS 304 Stem and ball, Teflon seat complete (PN-16). 25mm dia	ZOLOTO/SANT/ DRP	Each	17.00		
ROOF FIRE PANELS:						
43	Supply, installation, testing and commissioning of following integrated,	IMPACT ENGINEERS/ELEGANT	Each	1.00		
The following components and accessories shall be mounted with in each control panel.						
One no 100 amps TP incoming MCCB with the following:						
0-500 volts 96 x96 square mm voltmeter with sector switch and control fuses- 1 SET						
0-100 amps 96 x96 square mm ammeter with CT's and selector switch- 1 SET						
Including all electrical works						
Phase indicating lamp with toggle switches.						
Indication lamps for ON/OFF/TRIP status						
Outgoing Feeders / Starters as below:						
100 ATP MCCB with star / delta as starter suitable for 30 HP motor for Downcomer Pump - 1 Set						
Provision in control panel to connect flow switch for automatic operation of roof fire pumps.						
V TOTAL C/F TO SUMMARY						
PROPOSED FIRE HYDRANT WORK STATE BANK OF INDIA RBO						
S.	DESCRIPTION		Unit	Qty.	RATE	AMOUNT
SUB HEAD VI: FIRE HYDRANT WORKS RBO RANCHI BUILDING						
1	Supplying and fixing air vessel made of 250 mm dia, 8 mm thick MS sh	AUDCO/ZOLOTO/SANT/ DRP	Each	1.00		

2	Supplying and fixing single headed internal hydrant valve with instant	SAFEGUARD / NEWAGE/ FIRE SHIELD / LIFE GUARD	Set	5.00		
---	--	--	-----	------	--	--

S.	DESCRIPTION		Unit	Qty.	RATE	AMOUNT
	Single headed Gunmetal					
3	Supplying and fixing Single headed external yard hydrant valve with 1	SAFEGUARD / NEWAGE/ FIRE SHIELD / LIFE GUARD				
d	Single headed Gunmetal		Set	2.00		
4	Supplying and fixing first-aid Hose Reel with MS construction spray painted in post office red, conforming to IS 884 complete with the following as required.					
	20 mm nominal internal dia water hose thermoplastic (Textile reinforced) type -2 as per IS: 12585					
	20 mm nominal internal dia gun metal globe valve & nozzle.					
	Drum and brackets for fixing the equipment on wall					
	Connections from riser with 25 mm dia stop gun metal valve & M.S. Pipe and socket.					
	30 m		Set	6.00		
5	Supplying and fixing 63 mm dia, 15 m long RRL hose pipe with 63 mm	SAFEGUARD / NEWAGE/ FIRE SHIELD / LIFE GUARD				
	Gun Metal		Set	14.00		
6	Supplying & fixing 63 mm dia gun metal short branch pipe with 20 mm	SAFEGUARD / NEWAGE/ FIRE SHIELD / LIFE GUARD				
	Providing and fixing of standard short size GM branch pipe with nozzle of 20mm nominal bore outlet with instantaneous type 63 mm dia coupling complete IS marked & TAC approved.		Nos.	7.00		
7	Supplying and fixing of fire brigade connection of cast iron body with gun metal male instantaneous inlet couplings complete with cap and chain as reqd. for suitable dia MS pipe connection conforming to IS 904 as required:					
	4 way - 150 mm dia M.S. Pipe		Set	1.00		
8	Excavating trenches of required width for pipes, cables, etc. including excavation for sockets, and dressing of sides, ramming of bottoms, depth up to 1.5 m including getting out the excavated soil, and then returning the soil as required, in layers not exceeding 20 cm in depth including consolidating each deposited layer by ramming, watering, etc. and disposing of surplus excavated soil as directed, within a lead of 50 m:					
	All kinds of soil					
	Pipes, cables etc. exceeding 80 mm dia. but not exceeding 300 mm dia.		MTS	30		
9	Supplying, fixing, testing and commissioning of butterfly valve of PN 1.6 rating with bronze/gunmetal seat duly ISI marked complete with nuts, bolts, washers, gaskets conforming to IS 13095 of following sizes as required:	AUDCO/ZOLOTO/SA NT/ DRP				
A	100 mm dia		Each	1.00		
B	150 mm dia		Each	1.00		

10	Providing laying, testing & commissioning of 'C' class heavy duty MS Pipe conforming to IS 1239/3589 i/c fittings like elbows, tees, flanges, tapers, nuts bolts, gaskets etc. in ground including welding, excavation & providing cement concrete blocks as supports, anticorrosive treatment with coal tar/asphalt tape as per IS 10221, refilling the trench etc. of following sizes complete as required.	Jindal Hissar /TATA/Prakash Surya				
----	---	-----------------------------------	--	--	--	--

S.	DESCRIPTION		Unit	Qty.	RATE	AMOUNT
b	150 nominal bores (class C) including 100-65 dia pipe)		M	10.00		
11	Providing, laying, testing & commissioning of 'C' class heavy duty MS pipe conforming to IS 3589/IS 1239 including Welding, fittings like elbows, tees, flanges, tapers, nuts bolts, gaskets etc. and fixing the pipe on the wall/ceiling with suitable clamp/support frame and painting with two or more coats of synthetic enamel paint of required shade complete as required:	Jindal Hissar /TATA/Prakash Surya				
A	150 mm nominal bore (class C)		Rm	10.00		
B	100 mm nominal bore (class C)		Rm	20.00		
12	Providing & fixing flow switch in following sizes M.S. pipe including connection etc. as required. 100mm dia		Each	1.00		
13	Providing & fixing of pressure switch in M.S. pipe line including connection etc. as required.		Each	1.00		
14	Supply Installation and Testing of Air release valve shall be provided at all high point in the piping system for venting, valves shall be of the double float type. with G.M. body, vulcanite balls, rubber sealing , etc. Air valves shall be of the sizes specified and shall be associated with an equal size forged ball valve.		Each	1.00		
15	Providing and fixing of TAC approved 1.6mm thick M.S. fire hose cabinet (750x600x250mm) made out of 16-gauge M.S. sheet capable of accommodating landing valve, hose pipes, fittings & accessories. The box shall have a front glass door with lock and key arrangement & shall be painted with post office red colour (approval shall be taken on the basis of submitted sample before ordering) - for external and roof hydrant.	SAFEGUARD / NEWAGE/ FIRE SHIELD / LIFE GUARD	Each	7.00		
VI	TOTAL C/F TO SUMMARY					
	ANNUAL MAINTENANCE CHARGES (Annually), It should mandatorily not less than the Minimum Wage Policy (for skilled manpower) as applicable in Ranchi (otherwise it will not be accepted)		JOB	1		

Final Abstract OF COST

	DESCRIPTION					AMOUNT
. No						
I.	SUBHEAD-I: FIRE PUMPS AND HYDRANT WORKS.					

II	SUBHEAD-II: FIRE HYDRANT WORKS					
III	SUBHEAD III: FIRE HYDRANT ELECTRICAL WORKS					
IV	SUBHEAD-IV: PIPING FOR FIRE FIGHTING SYSTEM					
V	SUBHEAD- V: FIRE NON SCHEDULED ITEMS					
VI	SUB HEAD VI: FIRE HYDRANT WORKS RBO RANCHI BUILDING					

S.	DESCRIPTION	Unit	Qty.	RATE	AMOUNT
VII	SUB HEAD VIII: ANNUAL MAINTENANCE CHARGES (AMC) including one no. of semi-skilled manpower/technician				
	TOTAL AMOUNT OF SUB HEAD (I+II+III+IV+V+VI+VII)				
	IN WORDS: RUPEES				

Note: All materials, equipment, and services provided must strictly utilize the brands specified in this document. Any deviations, including requests to utilize alternative or equivalent brands, are subject to prior approval and verification by Bank.

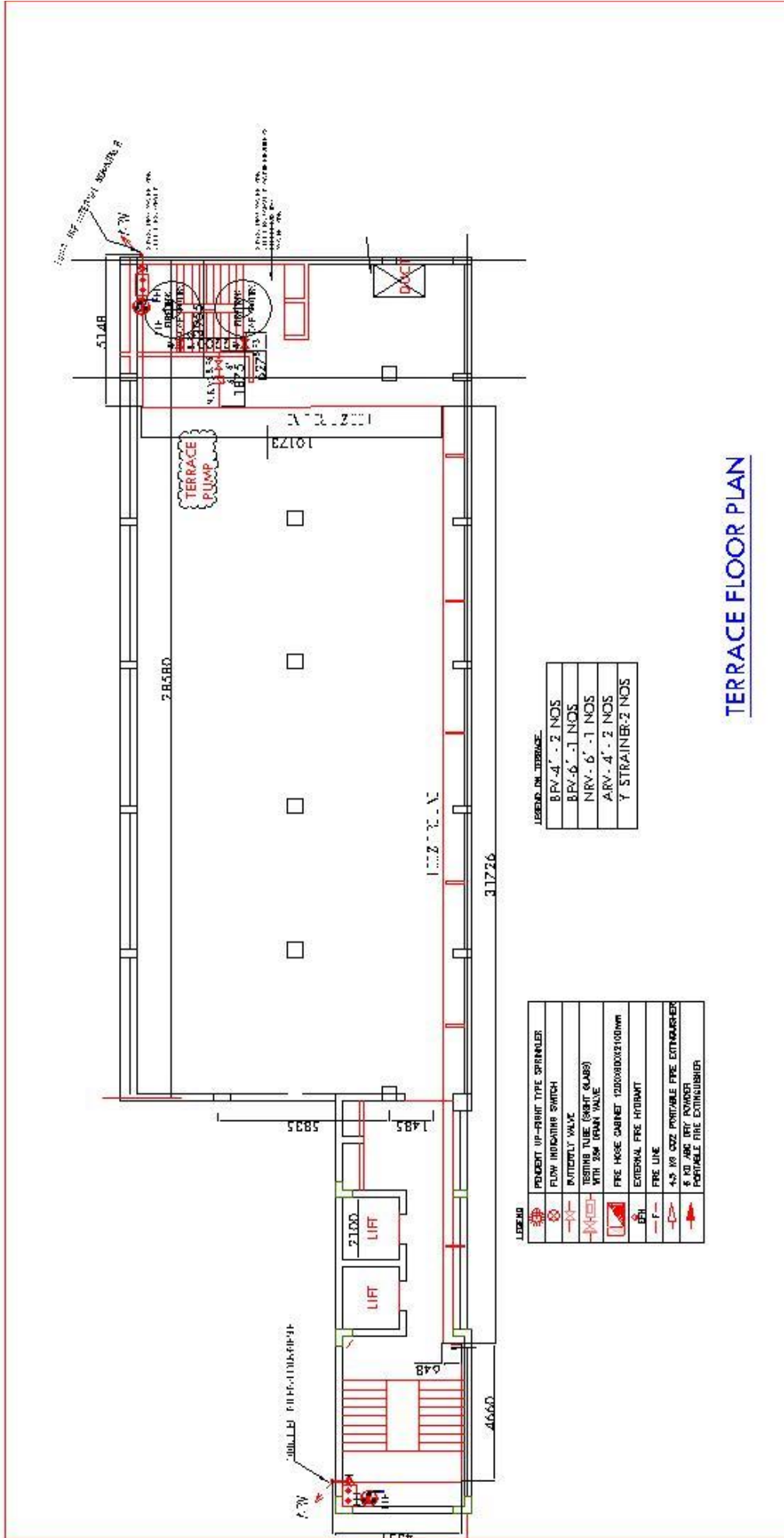

LEGEND

	PENDANT UP-RIBBIT TYPE SPRINKLER
	FLOW INDICATING SWITCH
	BUTTERFLY VALVE
	TESTING TUBE (SHUT GLASS) WITH 250 (PSI) VALVE
	FIRE HOSE CABINET (200000x2100mm)
	EXTERNAL FIRE HYDRANT
	FIRE LINE
	4.5 KG CO2 PORTABLE FIRE EXTINGUISHER
	8 KG ABC DRY POWDER PORTABLE FIRE EXTINGUISHER

LEGEND ON TERRACE

	BRV-4' - 2 NOS
	BRV-6' - 1 NOS
	NRV-6' - 1 NOS
	ARV-4' - 2 NOS
	Y STRAINER-2 NOS

TERRACE FLOOR PLAN

CLIENT :-
STATE BANK OF INDIA RANCHI

SHEET TITLE :-
TERRACE FLOOR PLAN

NOTES

CONCEPT DRAWING

ADVANCE CITY

NOT IN SCOPE

APPROVAL DRAWING

DRAWING NO. :-

DATE :-

ARCHITECTS

AR SINDHU SHAH
STERLING INFRA SERVICES
ARCHITECTS PLANNER NUMBER
DESIGNER
SPMC
FC9 BLOCK-B2 LUTUS APARTMENT
NEW PATLIPUTRA COLONY PATNA
-61-878614787
ar.sindhushah@gmail.com
www.sterlinginfra.com

