

Login : ARCHITECT / Plotted on : 12/20/2025 6:01:01 PM / Document : X:\State Bank Of India\SBI - MANGALORE MAIN BRANCH(NEW)\LHO Submitted All Drawings\Furniture Detail - (08.11.24).dwg

This drawing is the sole property and copyright of VISHWANATH & ASSOCIATES and cannot be reproduced in any form without the prior consent of the architects.

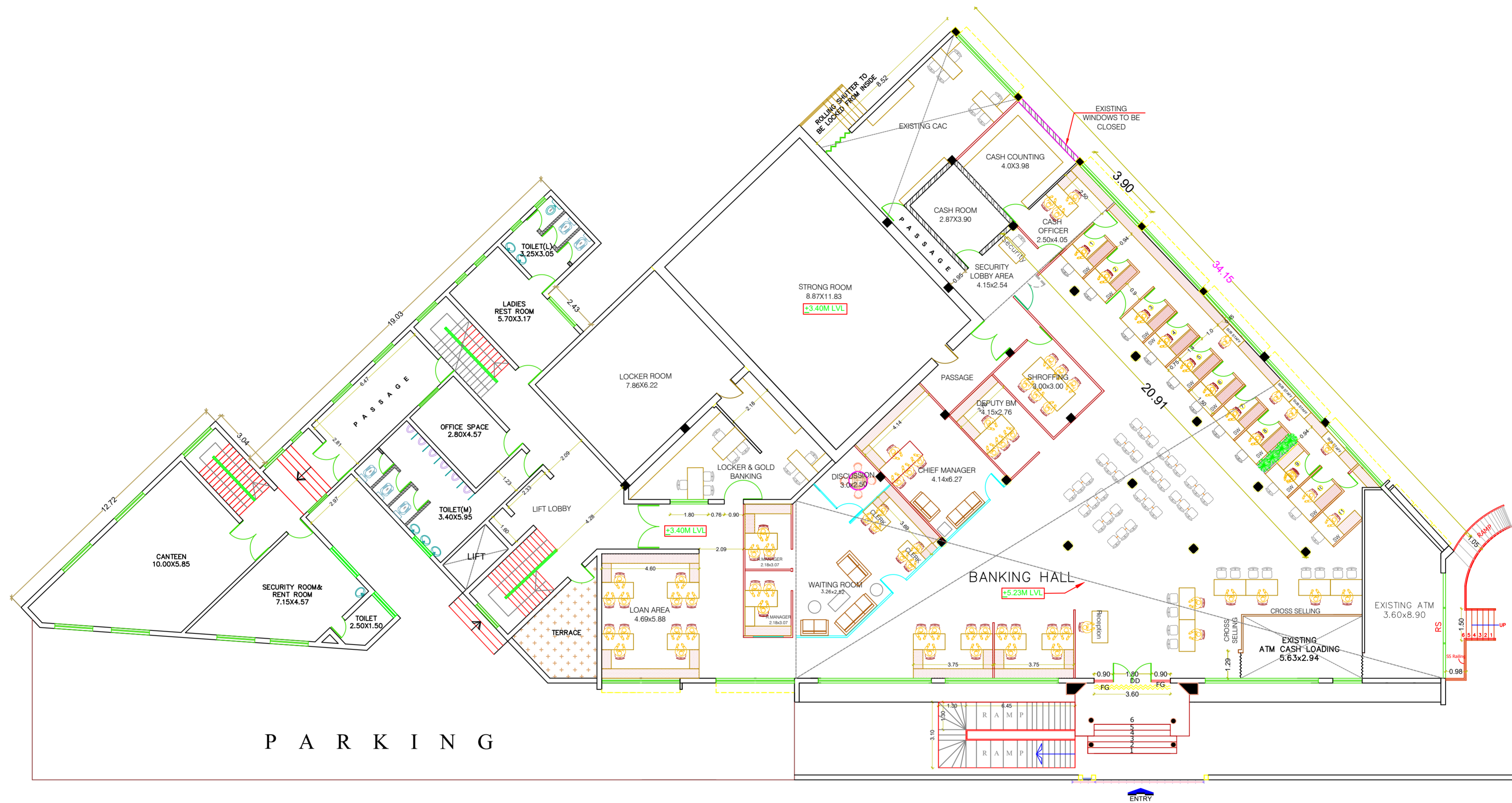

P A R K I N G

ENTRY

<b>PROJECT :</b> PROPOSED INTERIORS FOR STATE BANK OF INDIA, MANGALORE MAIN BRANCH	<b>DRAWING TITLE :</b> GROUND FLOOR FURNITURE LAYOUT PLAN		<b>LEGEND</b>  	<b>AREA</b>  	<b>NOTE:</b> <table border="1"> <thead> <tr> <th>REV.</th> <th>REVISION DESCRIPTION</th> <th>DATE</th> </tr> </thead> <tbody> <tr> <td>R7</td> <td>REVISED FLOOR PLAN</td> <td>05.11.24</td> </tr> <tr> <td>R8</td> <td>REVISED FLOOR Plan(existing plan)</td> <td>03.12.24</td> </tr> </tbody> </table>	REV.	REVISION DESCRIPTION	DATE	R7	REVISED FLOOR PLAN	05.11.24	R8	REVISED FLOOR Plan(existing plan)	03.12.24	<b>STATUS</b> FOR TENDER PURPOSE	<b>DWG NO.:</b> SH-02-SH
	REV.	REVISION DESCRIPTION				DATE										
R7	REVISED FLOOR PLAN	05.11.24														
R8	REVISED FLOOR Plan(existing plan)	03.12.24														
<b>CLIENT :</b> 	SCALE: N T S DEALT: JAHNAVI CHECKED: VR DATE: 03 - 12 - 24	<b>ARCHITECTS</b>  <b>VISHWANATH AND ASSOCIATES</b> ARCHITECTS, ENGINEERS & INTERIOR DESIGNERS 27, CASTLE STREET, CASTLE CHAMBERS, BANGALORE - 560025 PH NO : 080 - 25573350 / 25301779 plans@vishwanathandassociates.com														